

Instructions Klickfix



standard
Ø 22-26mm



oversize
Ø 31,8mm

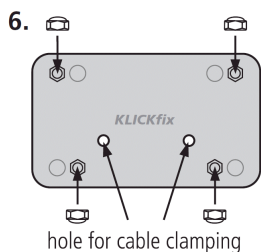
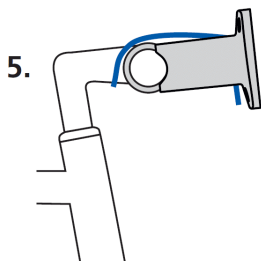
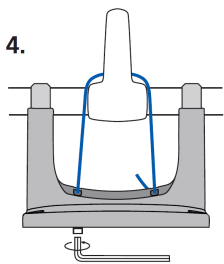
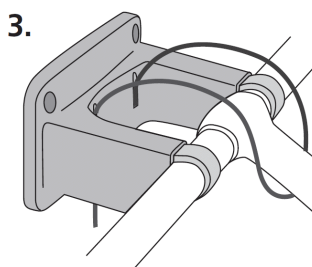
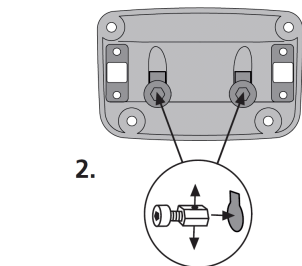
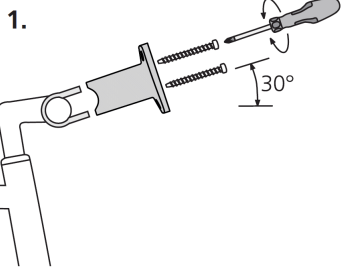

Allows for permanently installing an antenna on a bicycle handlebars.
Clamps for standard 22 to 26 mm and oversize handlebars Ø 31,8 mm included.

1. **Click both nylon straps** on the handlebar.
Shift housing on the straps.
Tighten the four cross bolts lightly.
Take care to have the holder fixed in slightly upward position.

2. **Insert the two locking nipples.**
Mind correct position of cable holes.

3. **Feed cable** from under front structure of handlebar into the locking nipples incorporated at the backside of the holder.
Pull both cable ends downwards equally through the locking bushings.

4. **Fix cable on one side** by tightening the locking bolt.
Pull the other end downwards firmly and tighten the bolt.
Take care to have both key bolts firmly tightened (5Nm).

5. **Push holder downwards** until it is stopped by the cable and tighten the 4 screws (1Nm).

7. **You can still adjust the accessory angle** through the little holes.

Important : We don't advise the use on carbon tubes.